

1 2 3 4 5 6

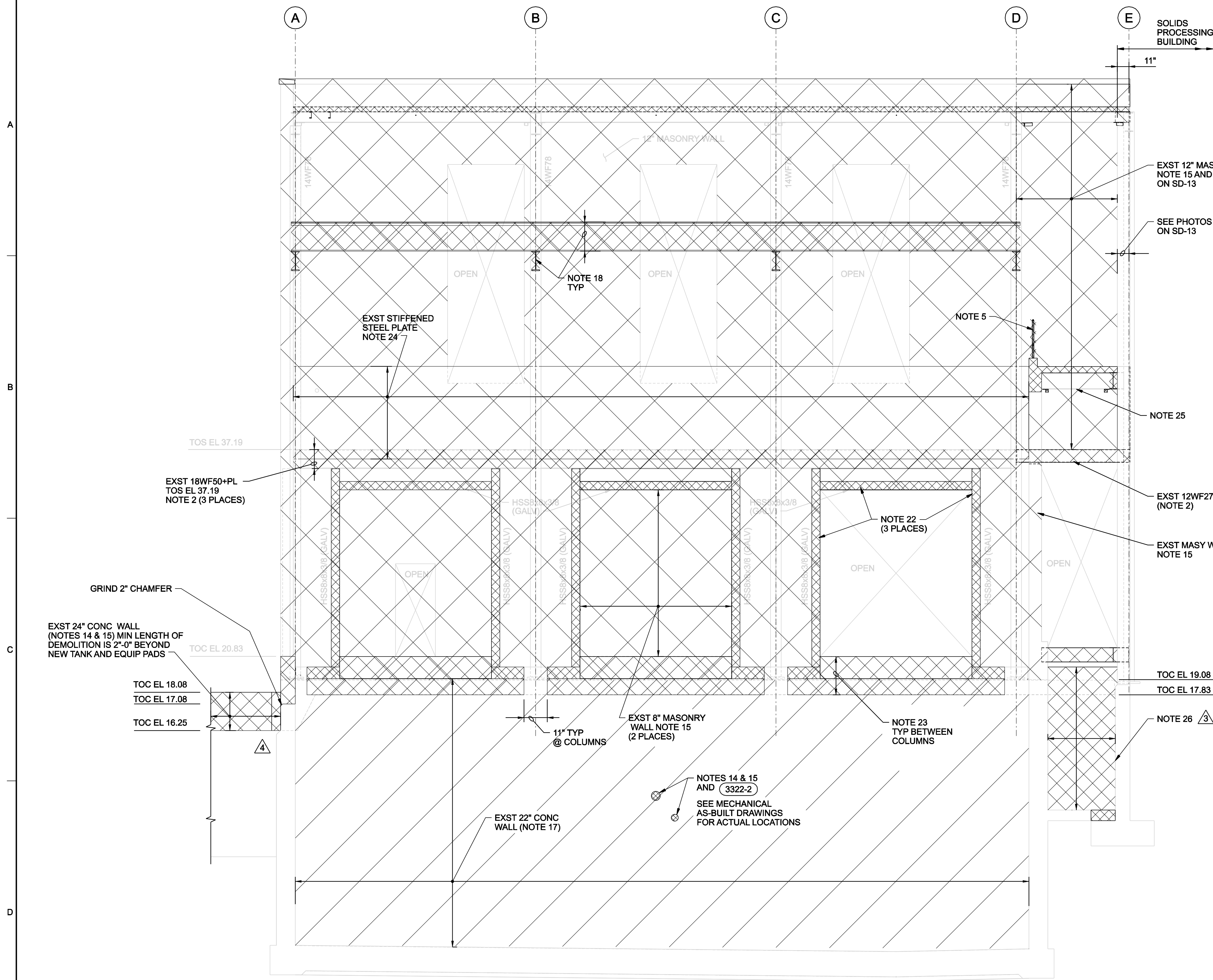

CONTRACTOR TO FIELD VERIFY ALL DIMENSIONS PRIOR TO INITIATING ANY DEMOLITION OR OTHER WORK INCLUDING ORDERING MATERIALS.

EXST 12" MASONRY NOTE 15 AND PHOTOS 5 AND 6 ON SD-13

SEE PHOTOS 5 AND 6 ON SD-13

EXST STIFFENED STEEL PLATE NOTE 24

NOTE 18 TYP

NOTE 5

NOTE 25

TOS EL 37.19

EXST 18WF50+PL TOS EL 37.19 NOTE 2 (3 PLACES)

EXST 12WF27+PL (TOS EL 37.19) (NOTE 2)

EXST MASY WALL, NOTE 15

GRIND 2" CHAMFER

EXST 24" CONC WALL (NOTES 14 & 15) MIN LENGTH OF DEMOLITION IS 2'-0" BEYOND NEW TANK AND EQUIP PADS

TOC EL 18.08  
TOC EL 17.08  
TOC EL 16.25

TOC EL 20.83

TOC EL 19.08  
TOC EL 17.83

11" TYP @ COLUMNS

EXST 8" MASONRY WALL NOTE 15 (2 PLACES)

NOTE 23 TYP BETWEEN COLUMNS

NOTE 26

NOTES 14 & 15 AND 3322-2  
SEE MECHANICAL AS-BUILT DRAWINGS FOR ACTUAL LOCATIONS

EXST 22" CONC WALL (NOTE 17)

LEGEND:

INDICATES DEMOLISH ELEMENTS. SCALE OF HATCH MAY VARY TO DIFFERENTIATE BETWEEN DEMOLITION OF LARGER AND SMALLER ELEMENTS.

INDICATES EXTENT OF EMBEDDED STL

NOTES:

SEE DRAWING SD-6 FOR NOTES 1 THROUGH 20.

- 22. DEMOLISH HSS8x8.
- 23. REMOVE CONCRETE DOWN TO EL 17.83
- 24. REMOVE EXISTING STEEL PLATE.
- 25. REMOVE EXISTING 16WF AND STORE FOR RE-USE.
- 26. REMOVE EXISTING CONCRETE WALL.

THESE RECORD DOCUMENTS HAVE BEEN PREPARED BASED ON THE INFORMATION PROVIDED BY OTHERS. THE DESIGN PROFESSIONAL HAS NOT VERIFIED THE ACCURACY AND/OR COMPLETENESS OF THIS INFORMATION AND SHALL NOT BE RESPONSIBLE FOR ANY ERRORS OR OMISSIONS WHICH MAY BE INCORPORATED HEREIN AS A RESULT.

**C** SECTION  
1/4"=1'-0"  
SD-4

RECORD DRAWING REVISION PER CCIR No. DR-14 REVISION PER CCIR No. DR-5 RE-ISSUED FOR CONSTRUCTION ISSUED FOR CONSTRUCTION FOR FINAL REVIEW/ BUILDING PERMIT		NO. DATE 5 01/20/08 4 02/05/07 3 10/18/06 2 09/09/06 1 07/04/06 0 06/19/06		DGN M. CHEZANOWSKI		DR A. CHADHA		CHK M. GOODSON		APVD B. GACKSTATTER	
STAMFORD WPCA		STAMFORD WATER POLLUTION CONTROL AUTHORITY		SOLIDS DRYING PROJECT		STRUCTURAL		DEMOLITION SECTION ALONG COLUMN LINE 2		VERIFY SCALE BAR IS ONE INCH ON ORIGINAL DRAWING. 0 1'	
DATE		JUNE 2006		PROJ		334058		DWG		SD-9	
SHEET		S8		FILENAME: std009_334058.dgn		MODIFIED DATE:		MODIFIED TIME:			

REUSE OF DOCUMENTS: THIS DOCUMENT AND THE IDEAS AND DESIGNS INCORPORATED HEREIN, AS AN INSTRUMENT OF PROFESSIONAL SERVICE, IS THE PROPERTY OF CH2M HILL AND IS NOT TO BE USED, IN WHOLE OR IN PART, FOR ANY OTHER PROJECT WITHOUT THE WRITTEN AUTHORIZATION OF CH2M HILL. © CH2M HILL 2004. ALL RIGHTS RESERVED.