

**INSTALLATION NOTES:**

1. EQUIPMENT CONNECTION JOINTS TO BE GASKETED.
2. GASKETS & HARDWARE PROVIDED BY ANDRITZ.
3. CONTRACTOR TO PROVIDE FILED DIMENSIONS REQUIRED FOR CHUTES AFTER EQUIPMENT IS INSTALLED.

TAG EQP'T 40.013.000

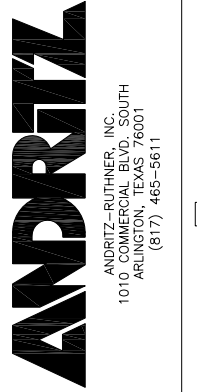

| REV | DESCRIPTION                      | DATE     |
|-----|----------------------------------|----------|
| 0   | FOR FINAL REVIEW/BUILDING PERMIT | 06/05/06 |
| 1   | UPDATED LAYOUT                   | 01/17/07 |

|                 |  |
|-----------------|--|
| DATE:           | 12/21/05   |
| CHECKED BY:     | JEN  |
| APPROVED BY:    |  |
| SCALE:          | 1/2"=1'-0"   |
| FILE:           | 152401320  |
| PROJECT NUMBER: | 1524   |
| TITLE:          | RECYCLE BIN (013)                                  |
| JOB NAME:       | CITY OF STAMFORD CONNECTICUT SOLIDS DRYING PROJECT |

|                 |  |
|-----------------|--|
| PROJECT NUMBER: | 1524   |
| TITLE:          | RECYCLE BIN (013)                                  |
| JOB NAME:       | CITY OF STAMFORD CONNECTICUT SOLIDS DRYING PROJECT |
| DATE:           | 12/21/05   |
| CHECKED BY:     | JEN  |
| APPROVED BY:    |  |
| SCALE:          | 1/2"=1'-0"   |
| FILE:           | 152401320  |
| PROJECT NUMBER: | 1524   |
| TITLE:          | RECYCLE BIN (013)                                  |
| JOB NAME:       | CITY OF STAMFORD CONNECTICUT SOLIDS DRYING PROJECT |

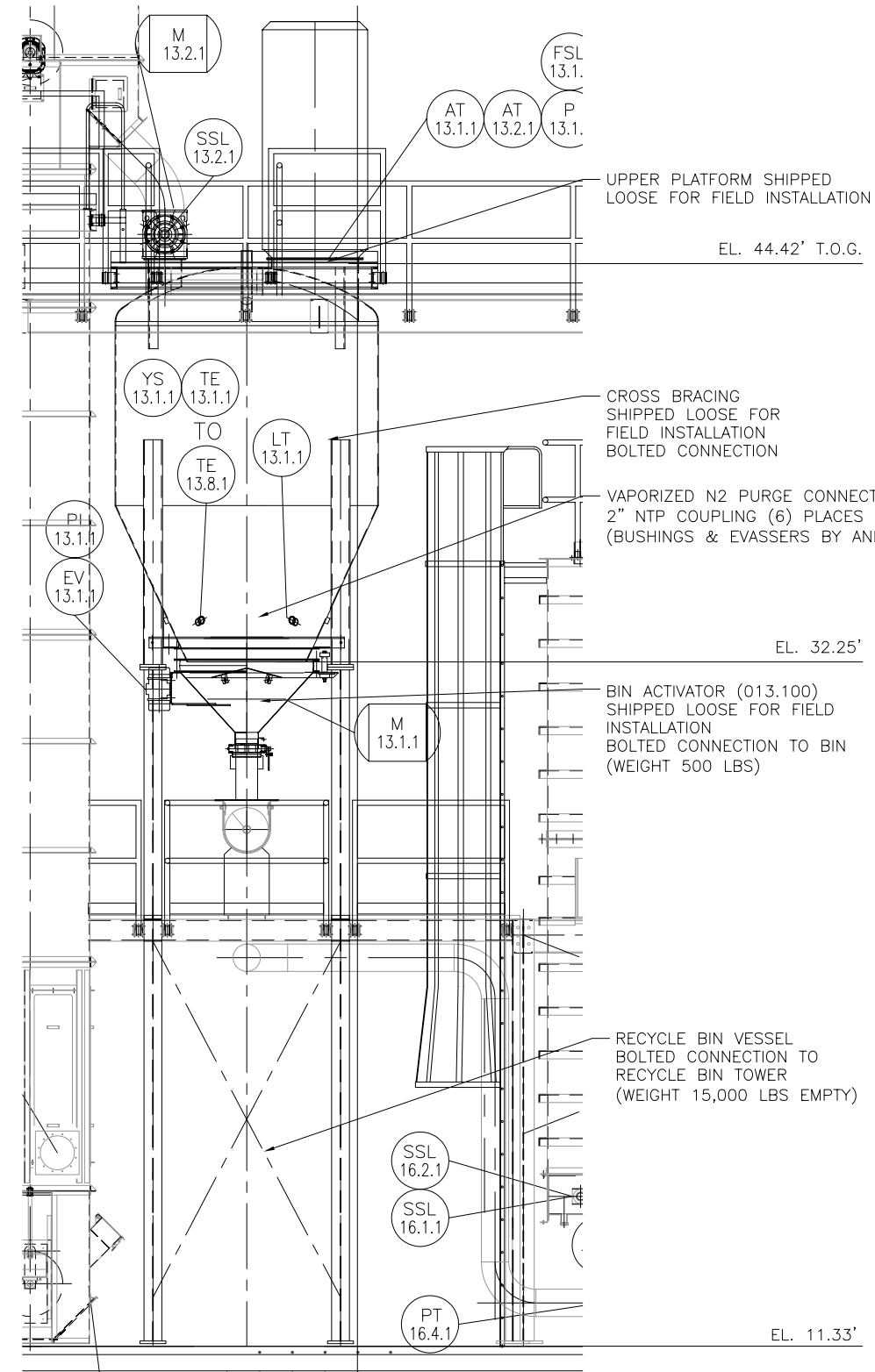

**ELEVATION VIEW**

SCALE: 3/8"=1'-0"

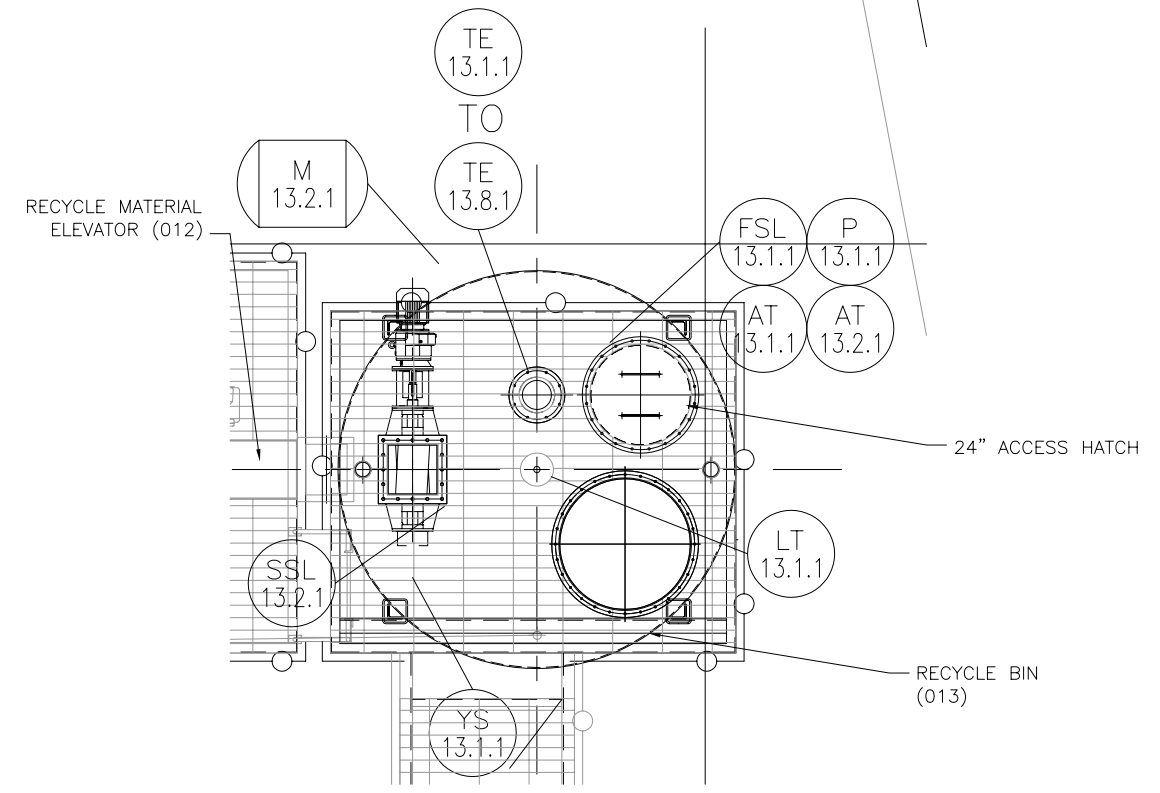

**PLAN VIEW**

SCALE: 1/2"=1'-0"

THIS DRAWING IS COPY RIGHTED. THIS DRAWING IS A TRADE SECRET AND ONLY ENTRUSTED TO THE RECEIVER FOR HIS PERSONAL USE WITHOUT THE SIGNED WRITTEN CONSENT OF ANDRITZ-RUTHNER, INC. IT MUST NOT BE COPIED NOR MADE AVAILABLE TO THIRD PARTIES, INCLUDING COMPETITORS, NOR MADE ACCESSIBLE TO SUCH PARTIES. ANY ILLEGAL USE BY THE RECEIVER OR THIRD PARTIES FOR WHICH HE IS RESPONSIBLE CAN CONSTITUTE A CAUSE FOR LEGAL ACTION. THIS DRAWING MUST BE RETURNED ON REQUEST OF THE COMPANY.

